

广州市商业储运联营公司用地平面图

8409.63  
2607.85

8410.31  
2607.85

界址点坐标表总面积			
点号	X	Y	边长
J1	2607892.856	38409878.599	2.11
J2	2607890.940	38409879.477	28.47
J3	2607867.990	38409896.323	24.04
J4	2607848.537	38409910.440	3.30
J5	2607845.745	38409912.202	1.05
J6	2607844.782	38409912.626	26.82
J7	2607819.296	38409920.984	3.31
J8	2607816.218	38409922.205	10.29
J9	2607806.820	38409926.385	12.55
J10	2607595.326	38409931.422	14.05
J11	2607593.077	38409945.290	1.10
J12	2607592.133	38409945.864	21.46
J13	2607573.543	38409956.586	22.78
J14	2607553.985	38409968.262	3.80
J15	2607550.723	38409970.202	5.16
J16	2607549.460	38409975.204	1.05
J17	2607548.915	38409976.101	4.36
J18	2607549.267	38409980.444	12.20
J19	2607544.066	38409991.482	1.01
J20	2607543.202	38409992.006	

界址点坐标表剩余面积地块一			
点号	X	Y	边长
J1	2607892.856	38409878.599	2.11
J2	2607890.940	38409879.477	28.47
J3	2607867.990	38409896.323	24.04
J4	2607848.537	38409910.440	3.30
J5	2607845.745	38409912.202	1.05
J6	2607844.782	38409912.626	26.82
J7	2607819.296	38409920.984	3.31
J8	2607816.218	38409922.205	10.29
J9	2607806.820	38409926.385	12.55
J10	2607595.326	38409931.422	14.05
J11	2607593.077	38409945.290	1.10
J12	2607592.133	38409945.864	21.46
J13	2607573.543	38409956.586	22.78
J14	2607553.985	38409968.262	3.80
J15	2607550.723	38409970.202	5.16
J16	2607549.460	38409975.204	1.05
J17	2607548.915	38409976.101	4.36
J18	2607549.267	38409980.444	12.20
J19	2607544.066	38409991.482	1.01
J20	2607543.202	38409992.006	

界址点坐标表剩余面积地块二			
点号	X	Y	边长
J21	2607543.459	38410033.223	6.53
J22	2607549.169	38410036.390	22.57
J23	2607567.507	38410049.549	14.68
J24	2607578.547	38410059.221	8.72
J25	2607587.128	38410060.766	13.67
J26	2607597.496	38410051.851	13.51
J27	2607610.069	38410046.901	9.87
J28	2607619.401	38410043.700	13.31
J29	2607632.352	38410040.622	33.22
J30	2607661.518	38410024.717	27.26
J31	2607685.474	38410011.709	13.48
J32	2607698.095	38410006.989	18.72
J33	2607715.836	38410001.001	11.86
J34	2607727.023	38409997.063	3.95
J35	2607730.376	38409994.984	4.05
J36	2607733.255	38409992.132	5.74
J37	2607736.436	38409987.352	20.09
J38	2607734.023	38409987.404	14.12
J39	2607722.564	38409959.159	

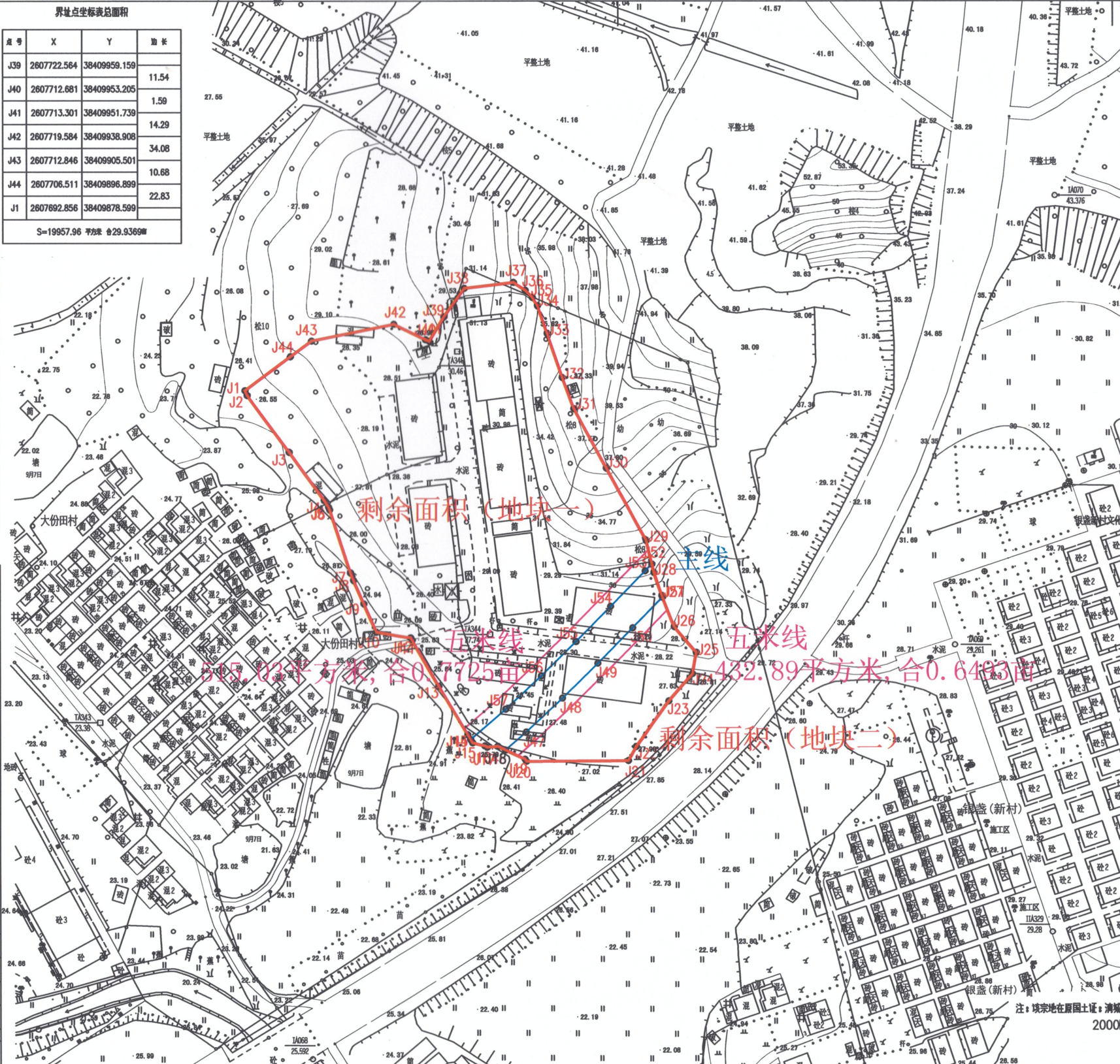

界址点坐标表主块			
点号	X	Y	边长
J45	2607552.026	38409969.427	1.52
J15	2607550.723	38409970.202	5.16
J16	2607549.460	38409975.204	1.05
J17	2607548.915	38409976.101	4.36
J18	2607549.267	38409980.444	3.44
J46	2607547.802	38409983.553	11.08
J47	2607555.013	38409991.971	20.11
J48	2607568.682	38410006.720	20.07
J49	2607582.759	38410021.027	20.03
J50	2607597.044	38410035.071	17.30
J51	2607609.434	38410047.151	0.68
J27	2607610.069	38410046.901	9.87
J28	2607619.401	38410043.700	3.52
J52	2607622.825	38410042.886	3.91
J53	2607620.023	38410040.155	20.00
J54	2607605.704	38410026.194	19.91
J55	2607591.507	38410012.237	19.78
J56	2607577.632	38409998.136	19.66
J57	2607564.268	38409983.716	18.82
J45	2607552.026	38409969.427	

界址点坐标表剩余面积地块二			
点号	X	Y	边长
J46	2607547.802	38409983.553	6.76
J19	2607544.066	38409991.482	1.01
J20	2607543.202	38409992.006	41.22
J21	2607543.459	38410033.223	6.53
J22	2607549.169	38410036.390	22.57
J23	2607567.507	38410049.549	14.68
J24	2607578.547	38410059.221	8.72
J25	2607587.128	38410060.766	13.67
J26	2607597.496	38410051.851	12.83
J51	2607609.434	38410047.151	17.30
J50	2607597.044	38410035.071	20.03
J49	2607582.759	38410021.027	20.07
J48	2607568.682	38410006.720	20.11
J47	2607555.013	38409991.971	11.08
J46	2607547.802	38409983.553	

清远市测绘地理信息中心



2607.41

2607.41

8409.63

8410.31

2019年4月数字化成图  
2000国家大地坐标系  
1985国家高程基准  
2017年版图式

1:2000



测量员: 龙 聪  
绘图员: 周中莹  
审核员: 何昌华